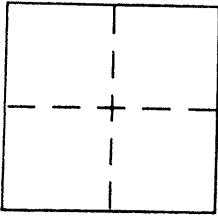

CORNER RECORD

BK 79 PG 4Document Number CR8079City of HaywardCounty of Alameda, CaliforniaBrief Legal Description Monuments along Happyland ave being preserved during construction

CORNER TYPE

Government Corner ☐ Control ☐
Meander ☐ Property ☒
Rancho ☐ Other ☐
Date of Survey 12/11/2015

COORDINATES (Optional)

N. _____
E. _____
Zone _____ NAD27 ☐ NAD83 ☐
NAD83 Epoch _____
Elev. _____
Vert. Datum: NGVD29 ☐ NAVD88 ☐
Meas. Units: Metric ☐ Imperial ☒

Corner - Left as found ☒ Found and tagged ☐ Established ☐ Reestablished ☐ Rebuilt ☐

Identification and type of corner found: Evidence used to identify or procedure used to establish or reestablish the corner:
Set stainless tags PLS 7905 for reference ties as shown on page 2

A description of the physical condition of the monument as found and as set or reset:

SEE LEGEND (Page 2)

SURVEYOR'S STATEMENT

This Corner Record was prepared by me or under my direction in conformance with

the Land Surveyor's Act on April 5, 2016

Signed [Signature] P.L.S or R.C.E. No. L.S. 7905



COUNTY SURVEYOR'S STATEMENT

This Corner Record was received 17 FEBRUARY, 2016

and examined and filed 14 APRIL, 2016

Signed Michael Rubin P.L.S or R.C.E. No. 6843

Title COUNTY SURVEYOR

County Surveyor's Comment _____

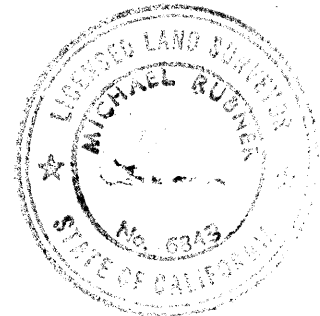

N 2069100.5
E 6096911.1

CF92J1

A STREET

HAPPYLAND AVE

N02°59'11"W 178.71'

REFERENCE:

PM 3269 121 MAPS 14

COORDS ARE CCS83 ZONE3 (2009.0)
LOCATED WITH GNSS ROVER AND
TIED TO LOCAL NGS HPGN GROUND
STATION CA 04 06 HT3667

N 2068922.1
E 6096920.4

BE81H7

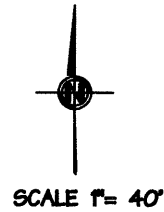

N. 2068783.9
E 6096878.9

LEGEND:

FOUND STANDARD ALAMEDA
COUNTY MONUMENT 
SET STAINLESS 
TAG L.S. 7905

ORO LOMA SEWER MANHOLE 
ALCO MONUMENT ID **AA##A#**
ALS JOB 2015-064

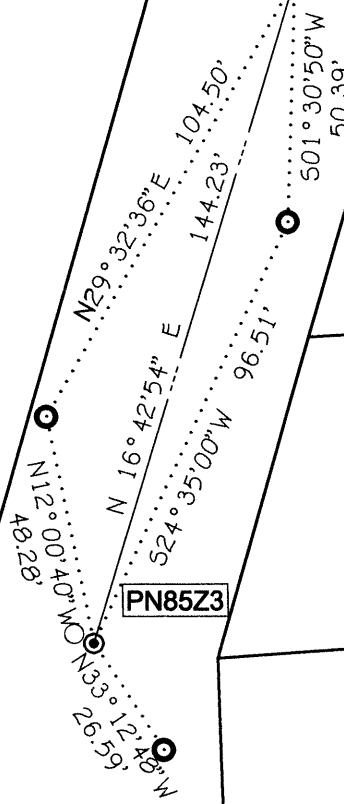

PN85Z3