

CORNER RECORD

City of Oakland (APN 41-4173-5-1)

Document Number BK 46 Pg 56
CR5077

County of Alameda, California

Brief Legal Description City of Oakland Monument 84G/20 near 7425 San Leandro Street

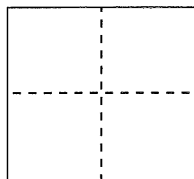

CORNER TYPE

Government Corner ☐ Control ☒
Meander ☐ Property ☐
Rancho ☐ Other ☐

Date of Survey August 7, 2012

COORDINATES (Optional)

N. _____
E. _____
Zone _____ NAD27 ☐ NAD83 ☐
NAD83 Epoch _____
Elev. _____
Vert. Datum: NGVD29 ☐ NAVD88 ☐
Meas. Units: Metric ☐ Imperial ☐

Pre-Construction (waterline) Corner Record

Corner - Left as found ☒ Found and tagged ☐ Established ☐ Reestablished ☐ Rebuilt ☐

Identification and type of corner found: Evidence used to identify or procedure used to establish or reestablish the corner:
Found 2-1/2" brass disc with punch in monument well per city of Oakland Monument Map No. 77. The purpose of this Corner Record is to preserve possible evidence only (prior to new waterline construction); no attempt was made to determine the relationship to property, center, or right of way lines.

A description of the physical condition of the monument as found and as set or reset:

Monument was referenced with set RP's representing two intersecting lines. Set concrete anchor nail with 1-1/4" brass washers stamped "EBMUD MON RP" on top of concrete curb as reference points (see page 2).

Reference EBMUD Field Book 4529, Pages 03-04

SURVEYOR'S STATEMENT

This Corner Record was prepared by me or under my direction in conformance with the Professional Land Surveyor's Act on August 13, 2012

Signed R. Lee Hixson P.L.S or R.C.E. No. 4806

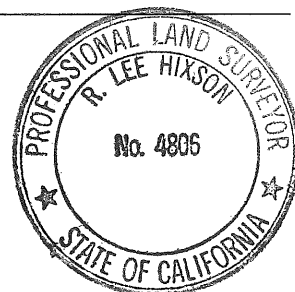

COUNTY SURVEYOR'S STATEMENT

This Corner Record was received 8-13-2012
and examined and filed 10-21-2012

Signed R. Penland P.L.S or R.C.E. No. 5726

Title COUNTY SURVEYOR

County Surveyor's Comment: _____



DZ73K7

