

# CORNER RECORD

Agency Index BK 129 PG 69  
Document Number CR12259

City of Hayward County of Alameda, California  
Brief Legal Description MON @ the end of Santa Fe St.

## CORNER TYPE

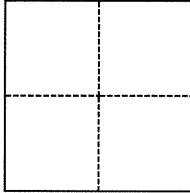

- ☐ Government Corner ☒ Control  
☐ Meander ☐ Property  
☐ Rancho ☐ Other

Date of Survey 9-12-18

## COORDINATES (Optional)

N. 2078353.04 E. 6098062.03  
Elevation \_\_\_\_\_

Units ☐ Metric ☒ U.S. Survey Foot

Horizontal Datum \_\_\_\_\_

Zone 3 Epoch Date \_\_\_\_\_

Vertical Datum \_\_\_\_\_

☐ Complies with Public Resources Code §§8801-8819

☐ Complies with Public Resources Code §§8890-8902

PLS Act Ref.:

☐ 8765(d)

☒ 8771

☐ 8773

☐ Other:

Corner/  
Monument:

☒ Left as found

☐ Established

☐ Rebuilt

☐ Pre-Construction

☐ Found and tagged

☐ Reestablished

☐ Referenced

☒ Post-Construction

Narrative of corner identified and monument as found, set, reset, replaced, or removed:

☐ See sheet #2 for description(s):

City Monument - CR10217

## SURVEYOR'S STATEMENT

This Corner Record was prepared by me or under my direction in conformance with

the Professional Land Surveyors' Act on

Signed

9-17-2018  
Joseph M. Brajkovich P.L.S. or R.C.E. No. 5254

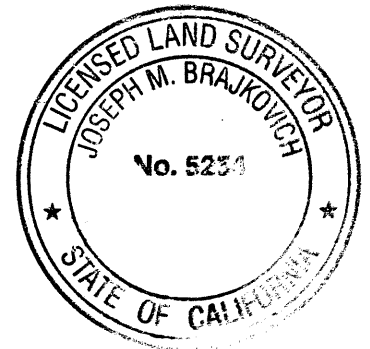

## COUNTY SURVEYOR'S STATEMENT

This Corner Record was received

2 OCTOBER 2018

and examined and filed

6 MAY 2019

Signed

Michael Rubner P.L.S. or R.C.E. No. 6843

Title

COUNTY SURVEYOR

County Surveyor's Comment

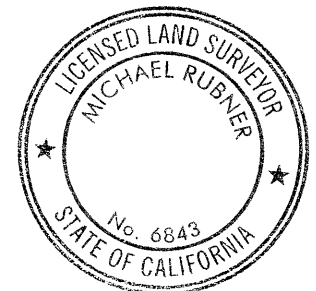

LEGEND

● MONUMENT

○ CUT X

REF.  
NORTH  
1" = 20'

