

CORNER RECORD

Document Number CR 5820

City of OAKLAND

County of ALAMEDA, California

Brief Legal Description LOTS 163 & 164 MERRIEWOOD (4 M 50)

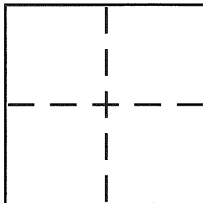

CORNER TYPE

Government Corner ☐ Control ☐
Meander ☐ Property ☒
Rancho ☐ Other ☐
Date of Survey AUG. 16, 2013

COORDINATES (Optional)

N. _____
E. _____
Zone _____ NAD27 ☐ NAD83 ☐
NAD83 Epoch _____
Elev. _____
Vert. Datum: NGVD29 ☐ NAVD88 ☐
Meas. Units: Metric ☐ Imperial ☐

Corner - Left as found ☐ Found and tagged ☐ Established ☒ Reestablished ☐ Rebuilt ☐

Identification and type of corner found: Evidence used to identify or procedure used to establish or reestablish the corner:

SEE OTHER SIDE

A description of the physical condition of the monument as found and as set or reset:

SEE OTHER SIDE

SURVEYOR'S STATEMENT

This Corner Record was prepared by me or under my direction in conformance with

the Land Surveyor's Act on SEPT. 16 2013

Signed Robert J. Brunel P.L.S. or R.C.E. No. 4961

COUNTY SURVEYOR'S STATEMENT

This Corner Record was received 9-18-2013

and examined and filed 10-15-2013

Signed Russell R. Penland P.L.S. or R.C.E. No. 5726

Title COUNTY SURVEYOR

County Surveyor's Comment _____

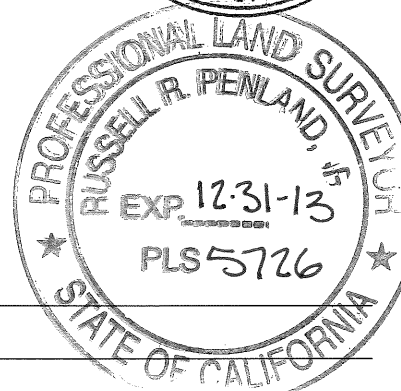
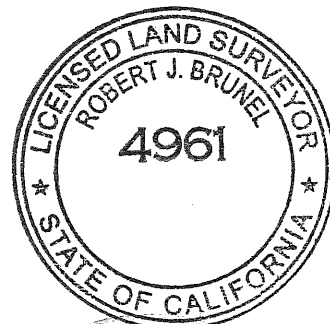

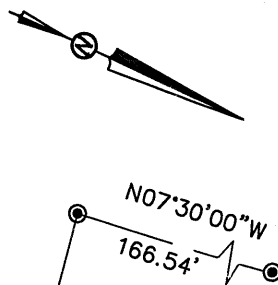

N07°30'00"W
166.54'

69.70'
N80°02'00"E

MERRIEWOOD DRIVE (50')

L=70.00 R=226.00
Δ=17°44'47"

L=48.00 R=102.00
Δ=26°57'41"

S23°20'00"E

120.22'

L=93.14 R=78.00
Δ=68°24'54"

TAURUS AVENUE (50')

LEGEND

- FOUND CONCRETE MONUMENT PER (4 M 50)
- SET 5/8" REBAR WITH PLASTIC CAP, LS 4961
- ✕ SET P.K. NAIL WITH BRASS TAG, LS 4961

S73°45'00"E (R)
L=30.00
Δ=1°59'20"

S41°45'00"E (R)
L=30.00
Δ=1°59'20"

L=8.97 R=102.00
Δ=5°02'19"

PM 2491

S25°09'50"E

165

113.66' (113.68')
S25°09'50"E

L=41.86 R=124.00
Δ=1°20'34"

CITY OF OAKLAND, COUNTY OF ALAMEDA, CALIFORNIA

CORNER RECORD
LOT 163 AND LOT 164
MERRIEWOOD (4 M 50)

AUGUST 16, 2013 SCALE: 1" = 40'

MONTCLAIR LAND SURVEYING

ROBERT J. BRUNEL - LICENSED LAND SURVEYOR
OAKLAND, CALIFORNIA

F.B. NO. 184

MERRIEWOOD CR.DWG

JOB NO. 13-526