

CORNER RECORD

COUNTY OF MNO T. 32 R. 27 E MERIDIAN CALIFORNIA

CORNER TYPE: GOV'T. CORNER ☒ MEANDER ☐ RANCHO ☐ CONTROL ☐ OTHER ☐
 CORNER IDENTIFICATION - DATE OF VISIT 1977

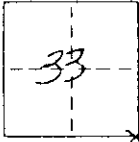

CORNER - LEFT AS FOUND ☒ FOUND AND TAGGED ☐ REESTABLISHED OBLITERATED CORNER ☐ REBUILT ☐

PHYSICAL DESCRIPTION OF CORNER FOUND: EVIDENCE AND METHOD USED TO IDENTIFY OR REESTABLISH

Found 2" iron pipe in hole 10' x 12" hole 10' x 12"
 2" x 2" hole 10' x 12" hole 10' x 12" hole 10' x 12"
 is 5' from 10' x 12" hole 10' x 12" hole 10' x 12"
 corner 10' x 12" hole 10' x 12" hole 10' x 12"
 10' x 12" hole 10' x 12" hole 10' x 12"

PHYSICAL DESCRIPTION OF MONUMENTS REBUILT OR PERPETUATED

CALIFORNIA COORDINATE SYSTEM ORDER: FIRST ☐ SECOND ☐ THIRD ☐

STATIONS USED: NGS (USC & GS) ☐ STATE ☐ COUNTY ☐ OTHER ☐ STATION _____ STATION _____
 ZONE _____ ELEVATION _____ NORTHINGS (Y) _____ EASTINGS (X) _____

SKETCH: (Include reference tie or witness points, remarks and topo of area)

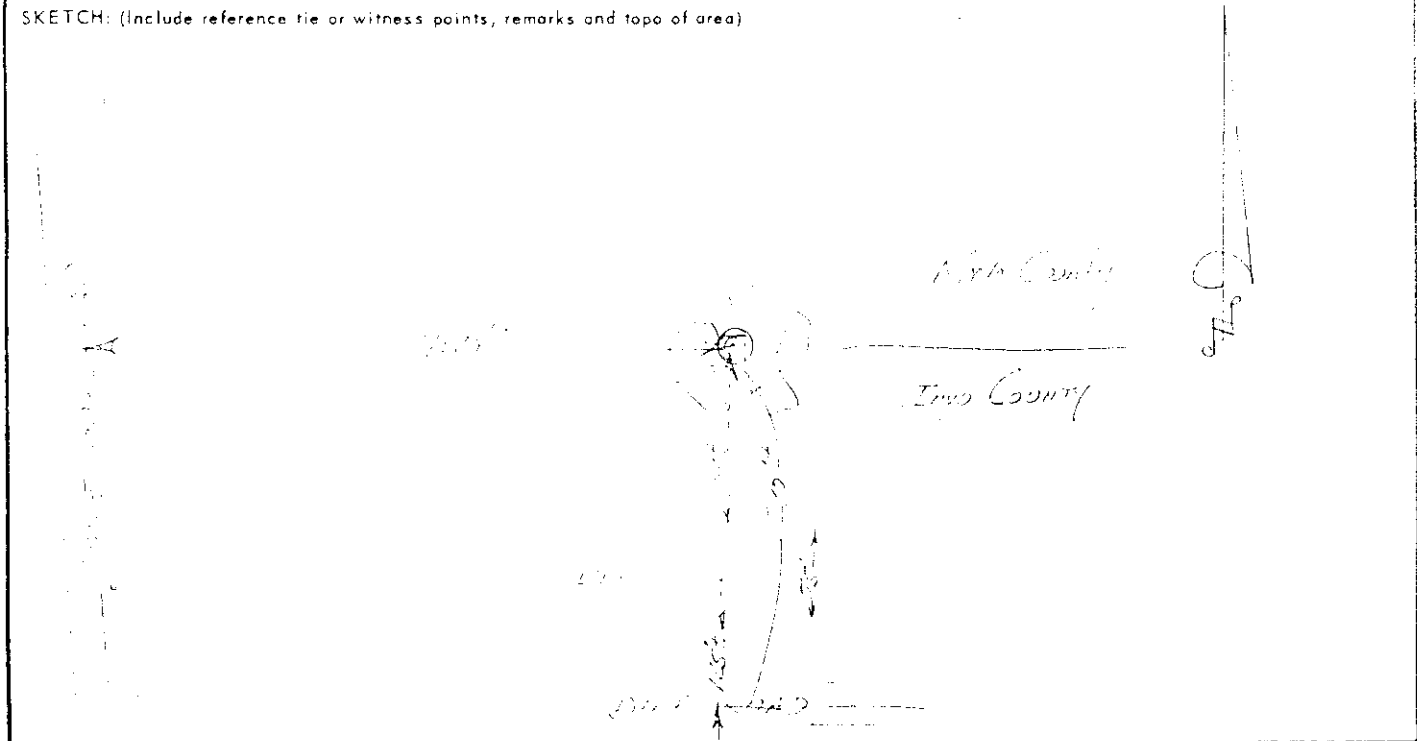

SURVEYOR'S CERTIFICATE

THIS CORNER RECORD WAS PREPARED BY ME OR UNDER MY DIRECTION IN CONFORMANCE WITH THE LAND SURVEYORS ACT ON 11/11/77 1977

SIGNED: _____

L.S. or R.C.E. No. 1000

SEAL

COUNTY SURVEYOR'S CERTIFICATE

THIS CORNER RECORD WAS RECEIVED _____ 19 _____
 AND EXAMINED AND FILED _____ 19 _____

BY: _____

TITLE: _____

DOCUMENT No. 5537-337

STATEMENT ON BACK OF SHEET

YES ☐ NO ☐