

OWNERS' STATEMENT

THE UNDERSIGNED HEREBY STATES THAT IT IS THE OWNER OF THE LAND DELINEATED AND EMBRACED WITHIN THE EXTERIOR BOUNDARY LINES ON THE HEREIN EMBODIED MAP ENTITLED "PARCEL MAP NO. 10284"; THAT SAID OWNER ACQUIRED TITLE TO SAID LAND BY VIRTUE OF THE DEED RECORDED DECEMBER 14, 2000 UNDER SERIES NO. 2000365205, OFFICIAL RECORDS OF ALAMEDA COUNTY, CALIFORNIA, THAT IT CONSENTS TO THE PREPARATION AND FILING OF THIS MAP.

BRIDGE HOUSING VENTURES, INC.
A CALIFORNIA NONPROFIT PUBLIC BENEFIT CORPORATION
BY:

Rebecca V. Hlebasko
REBECCA V. HLEBASKO, VICE PRESIDENT

OWNER'S ACKNOWLEDGMENT

STATE OF CALIFORNIA
COUNTY OF ALAMEDA

ON August 1, 2014, 2014, BEFORE ME, Flora Cortez
A NOTARY PUBLIC, PERSONALLY APPEARED REBECCA V. HLEBASKO, WHO PROVED TO ME ON THE BASIS OF SATISFACTORY EVIDENCE TO BE THE PERSON WHOSE NAME IS SUBSCRIBED TO THE WITHIN INSTRUMENT AND ACKNOWLEDGED TO ME THAT SHE EXECUTED THE SAME IN HER AUTHORIZED CAPACITY, AND THAT BY HER SIGNATURE ON THE INSTRUMENT THE PERSON, OR THE ENTITY UPON BEHALF OF WHICH THE PERSON ACTED, EXECUTED THE INSTRUMENT.

I HEREBY CERTIFY UNDER PENALTY OF PERJURY UNDER THE LAWS OF THE STATE OF CALIFORNIA THAT THE FOREGOING PARAGRAPH IS TRUE AND CORRECT.

WITNESS MY HAND:

SIGNATURE F. Cortez

PRINTED NAME Flora Cortez

PRINCIPLE PLACE OF BUSINESS (COUNTY) San Francisco

EXPIRATION OF COMMISSION November 7, 2014

COMMISSION NO. 1912370



CITY ENGINEER'S STATEMENT

I, MICHAEL J. NEARY, CITY ENGINEER, HAVING BEEN AUTHORIZED TO PERFORM THE FUNCTION OF THE CITY ENGINEER OF THE CITY OF OAKLAND, COUNTY OF ALAMEDA, STATE OF CALIFORNIA, DO HEREBY CERTIFY THAT I HAVE EXAMINED THE HEREIN EMBODIED PARCEL MAP ENTITLED "PARCEL MAP NO. 10284"; THAT THE SUBDIVISION AS SHOWN UPON SAID PARCEL MAP IS SUBSTANTIALLY THE SAME AS THAT APPEARING ON THE TENTATIVE PARCEL MAP AND ANY APPROVED ALTERATIONS THEREOF; THAT SAID PARCEL MAP COMPLIES WITH ALL THE PROVISIONS OF THE SUBDIVISION MAP ACT OF THE GOVERNMENT CODE OF THE STATE OF CALIFORNIA AND ANY LOCAL ORDINANCES APPLICABLE AT THE TIME OF APPROVAL OF THE TENTATIVE PARCEL MAP.

IN WITNESS WHEREOF, I HAVE HEREUNTO SET MY HAND THIS 21st DAY OF August, 2014.

Michael J. Neary
MICHAEL J. NEARY, R.C.E. NO. C38547
LICENSE EXPIRES: MARCH 31, 2015
CITY ENGINEER, CITY OF OAKLAND

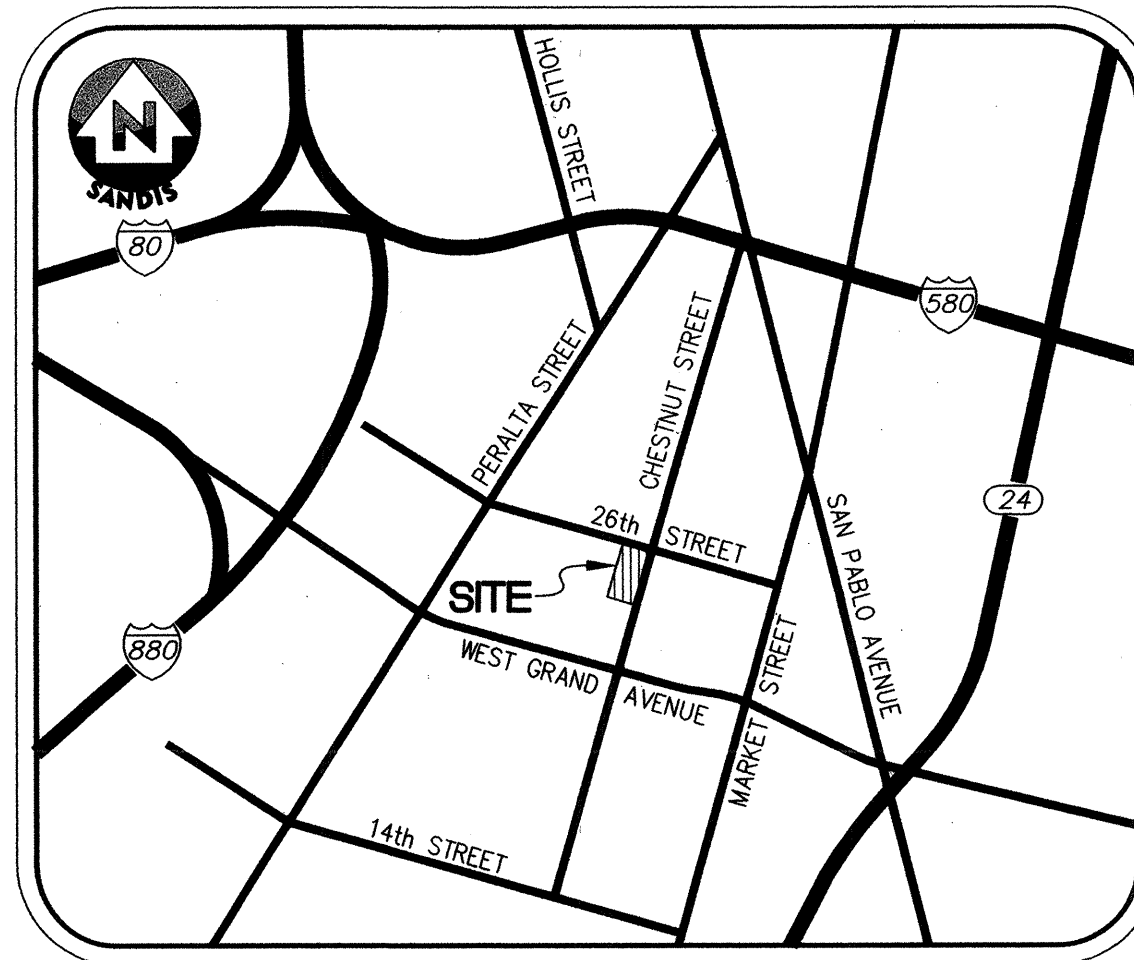
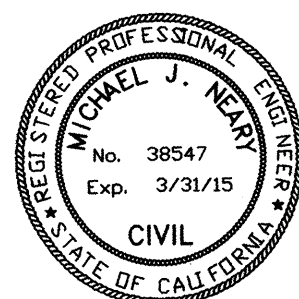

VICINITY MAP

NOT TO SCALE

CLERK OF THE BOARD OF SUPERVISORS STATEMENT

I, ANIKA CAMPBELL-BELTON, CLERK OF THE BOARD OF SUPERVISORS OF THE COUNTY OF ALAMEDA, STATE OF CALIFORNIA, DO HEREBY STATE THAT CERTIFICATES HAVE BEEN FILED AND DEPOSITS HAVE BEEN MADE IN CONFORMANCE WITH THE REQUIREMENTS OF SECTIONS 66492 AND 66493 OF THE GOVERNMENT CODE OF THE STATE OF CALIFORNIA.

DATED: August 21, 2014

ANIKA CAMPBELL-BELTON, CLERK OF THE BOARD OF SUPERVISORS,
COUNTY OF ALAMEDA, STATE OF CALIFORNIA

BY: *Samira James* #36393ce
DEPUTY CLERK

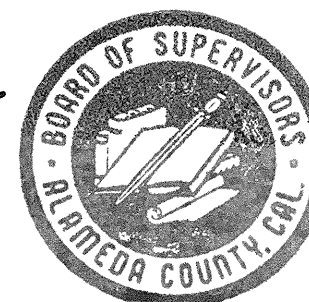

COUNTY RECORDER'S STATEMENT

FILED AT THE REQUEST OF CHICAGO TITLE COMPANY, AT 30 MINUTES PAST 8:00 O'CLOCK A. M. ON THE 28th DAY OF AUGUST, 2014, IN THE OFFICE OF THE COUNTY RECORDER OF THE COUNTY OF ALAMEDA, STATE OF CALIFORNIA, IN BOOK 326 OF PARCEL MAPS AT PAGES 56-57.

PATRICK J. O'CONNELL
COUNTY RECORDER IN AND FOR THE
COUNTY OF ALAMEDA, STATE OF CALIFORNIA

BY: *W. S. Sweeney*
DEPUTY COUNTY RECORDER



SURVEYOR'S STATEMENT

THIS PARCEL MAP WAS PREPARED BY ME OR UNDER MY DIRECTION AND IS BASED UPON A FIELD SURVEY IN CONFORMANCE WITH THE REQUIREMENTS OF THE SUBDIVISION MAP ACT AND LOCAL ORDINANCE AT THE REQUEST OF BRIDGE HOUSING VENTURES, INC. IN FEBRUARY, 2014. I HEREBY STATE THAT THE MONUMENTS ARE OF THE CHARACTER AND OCCUPY THE POSITIONS INDICATED AND THAT THE MONUMENTS ARE SUFFICIENT TO ENABLE THE SURVEY TO BE RETRACED, AND THAT THIS FINAL MAP SUBSTANTIALLY CONFORMS TO THE CONDITIONALLY APPROVED TENTATIVE MAP, AND ANY APPROVED ALTERATIONS THEREOF.

David W. Betham
DAVID W. BETHAM, P.L.S. NO. 7047
LICENSE EXPIRES: DECEMBER 31, 2014

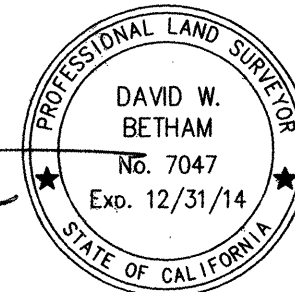

JULY 24, 2014

CITY SURVEYOR'S STATEMENT

I, GILBERT E. HAYES, HAVING BEEN AUTHORIZED TO PERFORM THE FUNCTIONS OF THE CITY SURVEYOR OF THE CITY OF OAKLAND, COUNTY OF ALAMEDA, STATE OF CALIFORNIA, DO HEREBY CERTIFY THAT I HAVE EXAMINED THE HEREIN EMBODIED PARCEL MAP ENTITLED "PARCEL MAP NO. 10284"; I AM SATISFIED THAT THE MAP IS TECHNICALLY CORRECT.

IN WITNESS WHEREOF, I HAVE HEREUNTO SET MY HAND THIS 20th DAY OF August, 2014.

Gilbert E. Hayes
GILBERT E. HAYES, P.L.S. NO. 4700
LICENSE EXPIRES: SEPTEMBER 30, 2015
CITY SURVEYOR, CITY OF OAKLAND



SEISMIC HAZARD NOTE

THE REAL PROPERTY LIES WITHIN THE FOLLOWING HAZARDOUS AREA: A SEISMIC HAZARD ZONE- LIQUIFICATION ZONE PURSUANT TO SECTION 2696 OF THE PUBLIC RESOURCES CODE. THESE HAZARDS MAY LIMIT YOUR ABILITY TO DEVELOP THE REAL PROPERTY, TO OBTAIN INSURANCE, OR TO RECEIVE ASSISTANCE AFTER A DISASTER. THE MAPS ON WHICH THESE DISCLOSURES ARE BASED ESTIMATE WHERE NATURAL HAZARDS EXIST. THEY ARE NOT DEFINITIVE INDICATORS OF WHETHER OR NOT A PROPERTY WILL BE AFFECTED BY A NATURAL DISASTER. TRANSFEREE(S) AND TRANSFEROR(S) MAY WISH TO OBTAIN PROFESSIONAL ADVICE REGARDING HAZARDS AND OTHER HAZARDS THAT MAY AFFECT THE PROPERTY.

PARCEL MAP NO. 10284

BEING A MERGER OF PARCELS 1 THROUGH 4, DOC. NO. 2000-365205, IN BLOCK 641, BOARDMAN'S MAP OF OAKLAND AND VICINITY, FILED APRIL 23, 1883 IN MAP BOOK 17, AT PAGE 14, ALAMEDA COUNTY RECORDS
CITY OF OAKLAND JULY 2014 COUNTY OF ALAMEDA



SANDIS

CIVIL ENGINEERS
SURVEYORS
PLANNERS

936 E. Duane Avenue | Sunnyvale, CA 94085 | P. 408.636.0900 | F. 408.636.0999 | www.sandis.net

SUNNYVALE

ROSEVILLE

OAKLAND

Parcel map 10284
map bk 326 p. 56