

CORNER RECORD

BK 57 PG 47

APN No. _____ (Optional) Document Number CR 4137
 City of Unincorporated Hayward County of ALAMEDA, California
 Brief Legal Description Found Iron Bolt at an angle point in Hampton Rd. (5'southerly of centerline)

CORNER TYPE

Government Corner ☐ Control ☐
 Meander ☐ Property ☐
 Rancho ☐ Other ☐
 Date of Survey April 5, 2010

COORDINATES (Optional)

N. _____
 E. _____
 Zone _____ Datum _____
 Elev. _____

Corner - Left as found ☒ Found and tagged ☐ Established ☐ Reestablished ☐ Rebuilt ☐

In compliance with Section 8771 of the Professional Land Surveyors' Act, this corner record is being filed to ESTABLISH X / REESTABLISH _____ the position of an existing monument PRIOR X / SUBSEQUENT _____ to street or highway reconstruction. (Use this portion only when applicable.)

Identification and type of corner found: Evidence used to identify or procedure used to establish or reestablish the corner:
Foundard Iron Bolt at angle point in Hampton Rd., offset 5' southerly of the centerline.
Set 3 scribed crosses and a mag nail as reference points along diagonal lines (See Pg 2)

A description of the physical condition of the monument as found and as set or reset: _____
Monument found undisturbed, in good condition. The record location of the monument is
5' southerly of the centerline of Hampton Rd. as per References shown on Page 2

SURVEYOR'S STATEMENT

This Corner Record was prepared by me or under my direction in conformance with the Land Surveyors' Act on April 9, 2010.
 Signed Albert Jordan L.S. or R.C.E. Number LS 6623

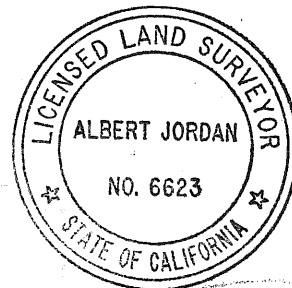

COUNTY SURVEYOR'S STATEMENT

This Corner Record was received 4-8 2010 and examined and filed 1-13 2010.
 Signed [Signature] Title: County Surveyor

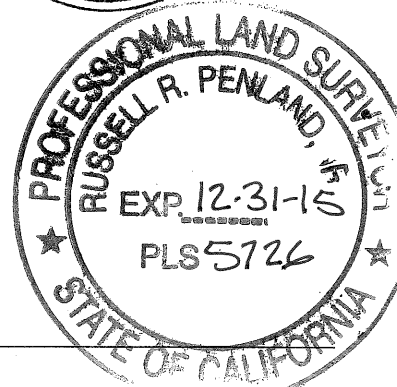

County Surveyor's Comment _____

LEGEND

NA44C6

Alameda County Monument
ID Number ("PTa...")

SSMG

Survey Set Mag Nail

SFIB

Survey Found Iron Bolt

SSSX

Survey Set Scribed Cross

REFERENCES

Colonial Acres (3 M 63)

Parcel Map 1170 (80 M 38)

Parcel Map 6015 (200 M 46)

Parcel Map 6704 (215 M 33)

Scale: 1" = 40'

