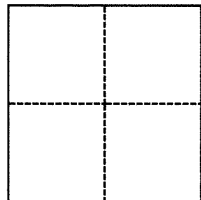

CORNER RECORD

Agency Index BK 140 Pg 31Document Number CR 14960City of Castro Valley County of Alameda, CaliforniaBrief Legal Description Tract 3467 Lot 6, Blk. A (Bk 82 Maps Pg 71), APN: 084B-0455-053**CORNER TYPE****COORDINATES (Optional)**

- ☐ Government Corner ☐ Control
☐ Meander ☒ Property
☐ Rancho ☐ Other

N. _____ E. _____

Elevation _____

Units ☐ Metric ☒ U.S. Survey Foot

Horizontal Datum _____

Zone _____ Epoch Date _____

Vertical Datum _____

☐ Complies with Public Resources Code §§8801-8819☐ Complies with Public Resources Code §§8890-8902PLS Act Ref.: ☒ 8765(d) ☐ 8771 ☐ 8773 ☐ Other:

Corner/
Monument: ☐ Left as found ☒ Established ☐ Rebuilt ☐ Pre-Construction
☐ Found and tagged ☐ Reestablished ☐ Referenced ☐ Post-Construction

Narrative of corner identified and monument as found, set, reset, replaced, or removed:

☒ See sheet #2 for description(s):

Found, Checked and Held three (3) subdivision monuments in Monument wells on the monument line of Stanton Heights Court as shown on map of Tract 3467 (Bk.82 Maps Pg.71) found as described and used to establish the boundaries of the Subject Parcel.

Set 5/8" rebar and yellow plastic cap, stamped PLS #6437 at front corner common to Lot 6 and Lot 7, and also as a Point-on-Line common to Lot 6 and Lot 7.

SURVEYOR'S STATEMENT

This Corner Record was prepared by me or under my direction in conformance with

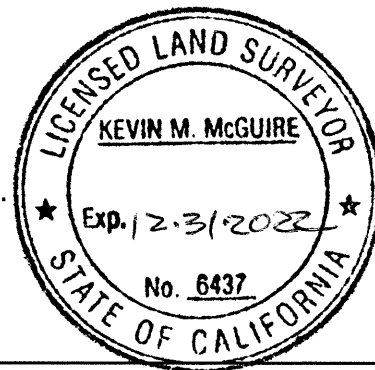
the Professional Land Surveyors' Act on April 29, 2021Signed Kevin M. McGuire P.L.S. or R.C.E. No. 6437**COUNTY SURVEYOR'S STATEMENT**This Corner Record was received AUG 04 2021and examined and filed AUG 09 2021Signed D. Ian Wilson P.L.S. or R.C.E. No. 7010Title ALAMEDA COUNTY SURVEYOR

County Surveyor's Comment

